

Central Corridor Light Rail Transit

Transportation Committee
July 23, 2012



*Improving
mobility*

*Easing
congestion*

*Strengthening
our communities*

Background



- Previously planned to locate TPSS 12 at corner of Cedar and 5th
- City of St. Paul requested it be relocated to the southeast corner of Capital City Parking Ramp.
- Requires permanent easement, ingress and egress to operate and maintain TPSS -12

Location of TPSS 12

Original TPSS
#12 Location

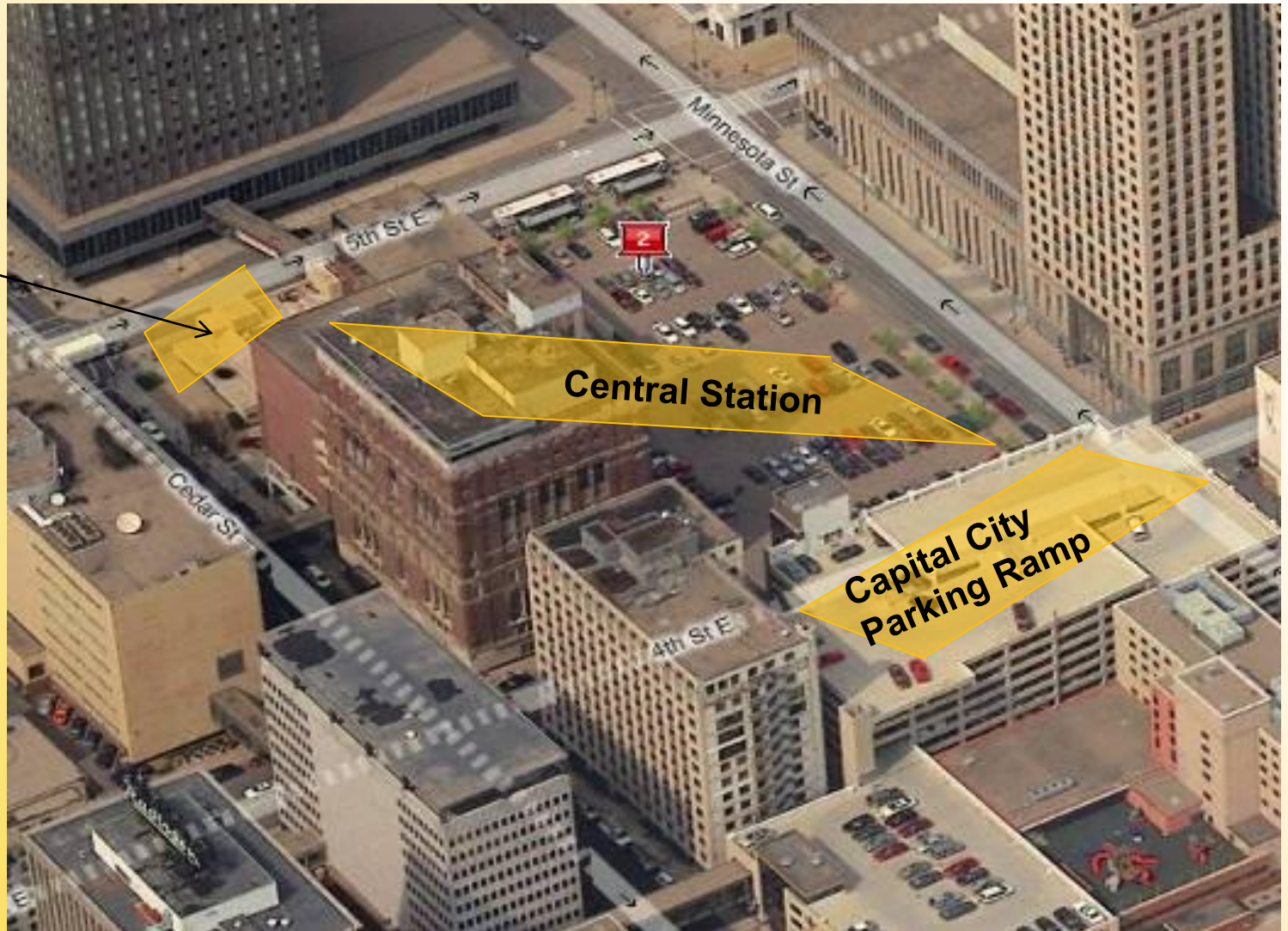

Central Station

Capital City
Parking Ramp

TPSS 12 Overlay

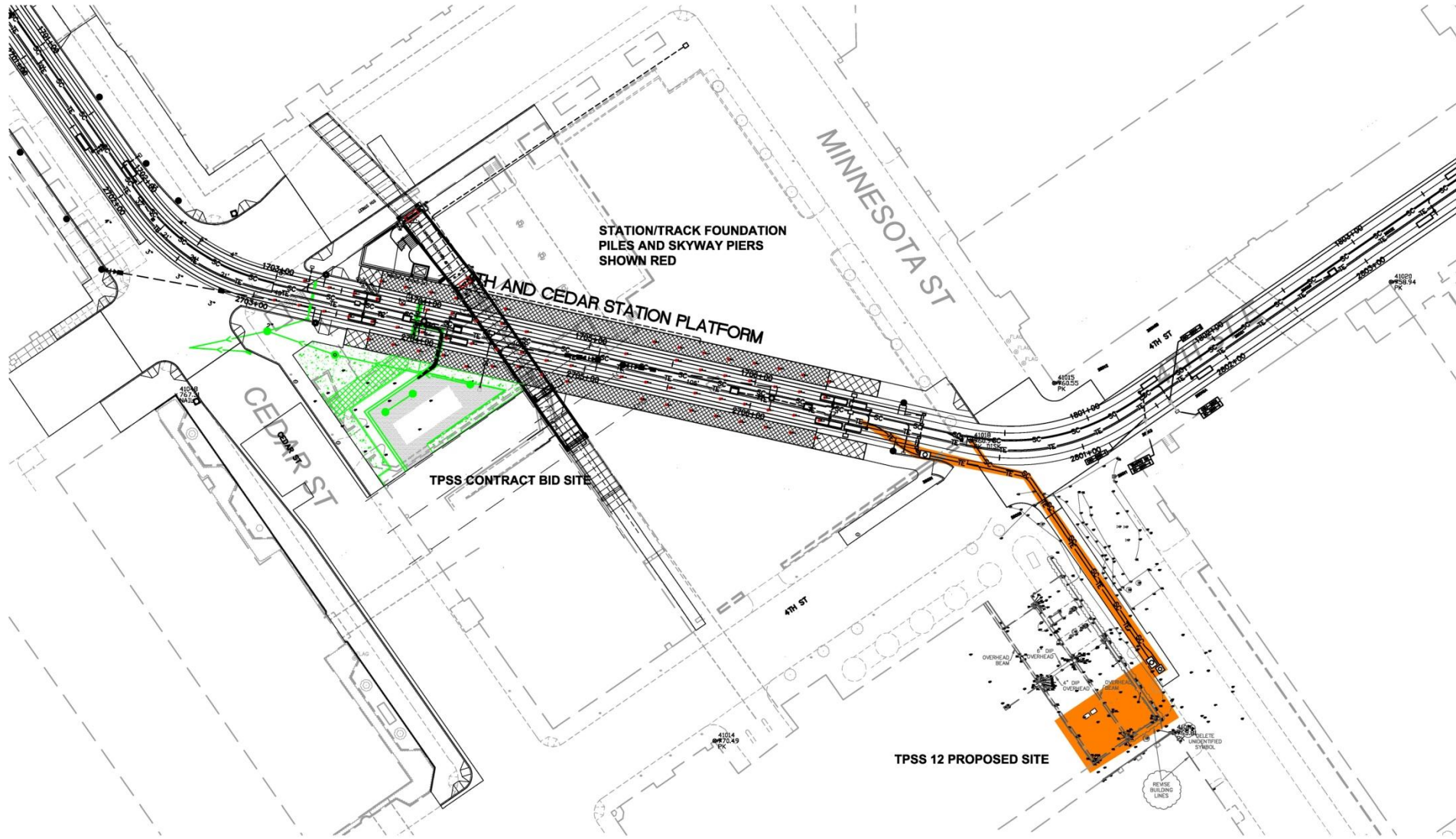

9/9/2011

- Authorize Regional Administrator to:
 - 2012-231: Execute a Funding Agreement with St. Paul requiring City to reimburse Met Council for cost of Permanent Easement with St. Paul Port Authority for Traction Power Sub Station 12 (TPSS -12) in Capital City Parking Ramp.
 - 2012-232: Execute a Permanent Easement Agreement with Port Authority of the City of St. Paul and Wells Fargo Bank National Association for permanent location of Traction Power Sub Station 12 (TPSS -12) in Capital City Parking Ramp.

More Information

Check out our website:

- www.centralcorridor.org

Contact the Central Corridor Project Office:

- 540 Fairview Avenue North
St. Paul, MN 55104
- Construction Hotline: 651-602-1404
- Comment Line: 651-602-1645
- Email: centralcorridor@metc.state.mn.us

